

UltraBag Aseptic Exchange Procedure

UltraBag –The system you can trust

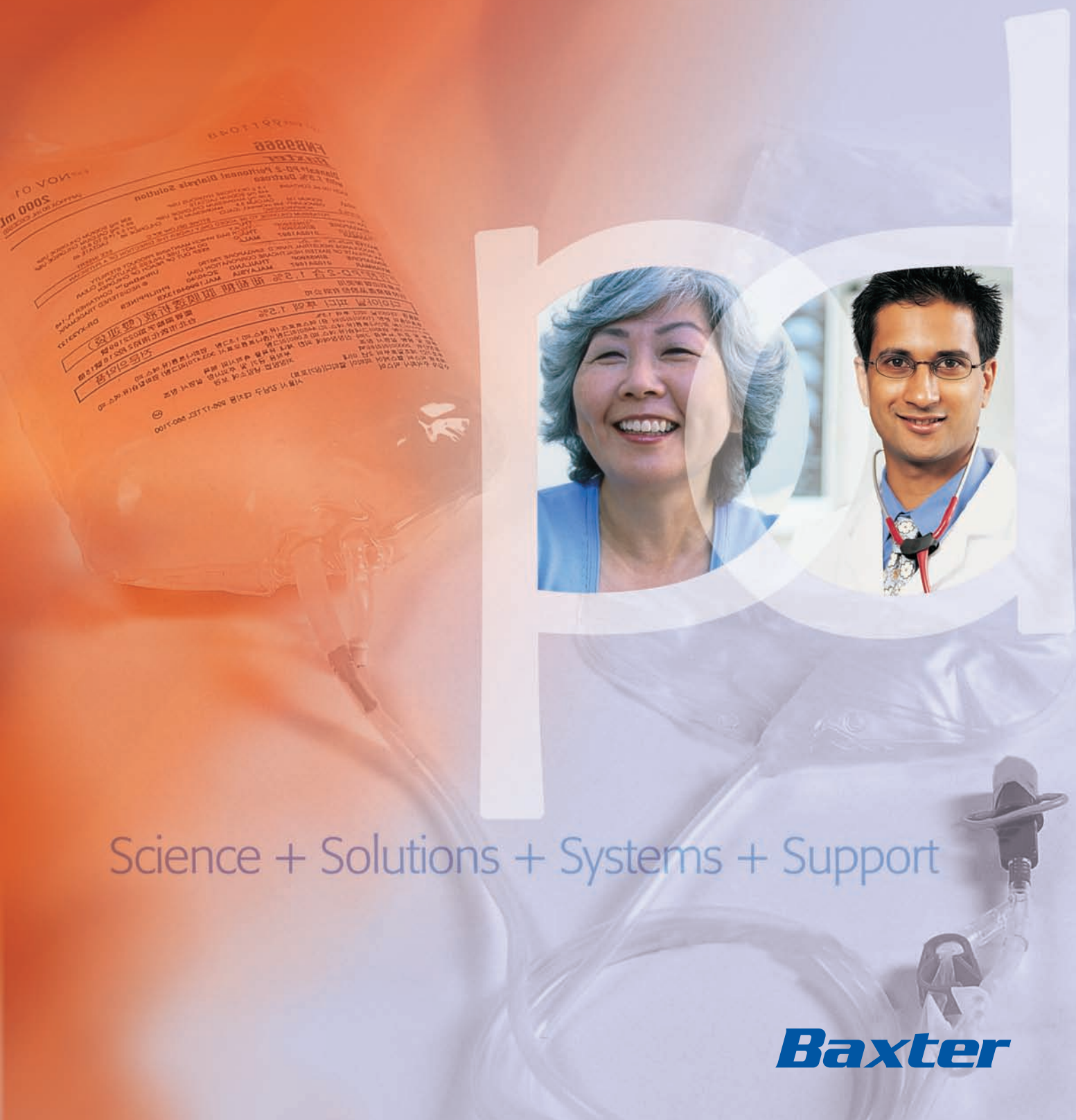

Science + Solutions + Systems + Support

Baxter

UltraBag Aseptic Exchange Procedure

1 Prepare Supplies

- Clean work area.
- Gather supplies–UltraBag, mask, disconnect cap.
- Remove UltraBag from overpouch and inspect EXP date, consistency, pull ring, tubing, frangible and new solution bag.
- Remove transfer set from clothing. Make sure it is closed.
- Mask and wash hands.
- If prescribed, add medication per your physician's instructions.



2 Connect to UltraBag

- Clamp blue clamp on fill line of UltraBag.
- Break frangible near solution bag.
- Remove disconnect cap from transfer set.
- Remove pull ring from UltraBag .
- **Immediately** connect transfer set to UltraBag . Holding transfer set steady while twisting on UltraBag until firmly secured.

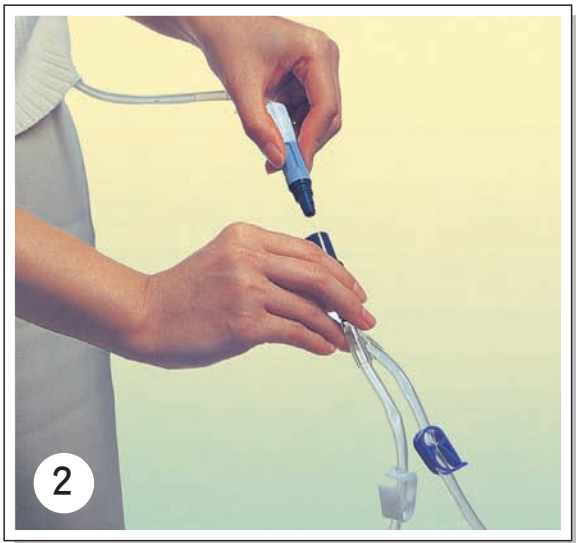

3 Drain

- Hang new solution bag.
- Place drain bag in drain position.
- Open transfer set to drain. Observe effluent for cloudiness.
- When drainage is complete, close transfer set.



4 Flush

- Open blue clamp on fill line.
- Count to 5 slowly and watch new solution flow into drain bag.
- Clamp white clamp on drain line.

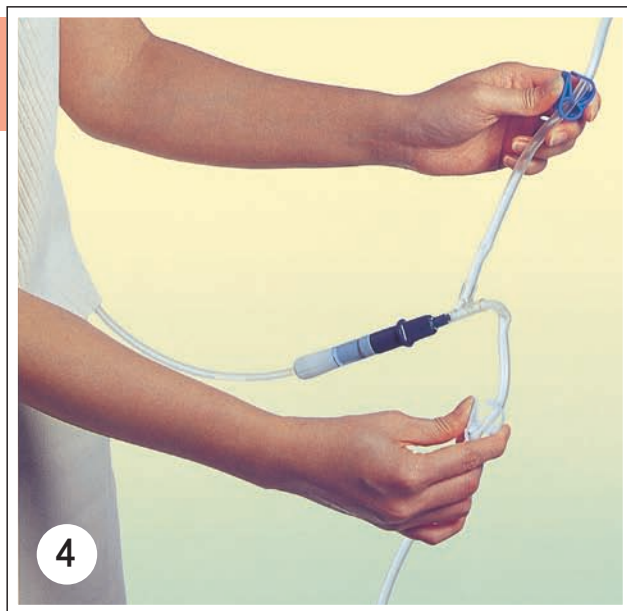

5 Fill

- Open transfer set to fill.
- When fill is complete, close transfer set.
- Clamp blue clamp on fill line.

6 Cap Off

- Open disconnect cap package.
- Check sponge in cap visually for wetness.
- Disconnect UltraBag from transfer set.
- With transfer set pointing down, point disconnect cap up and twist it into transfer set until firmly secured.
- Discard used supplies.

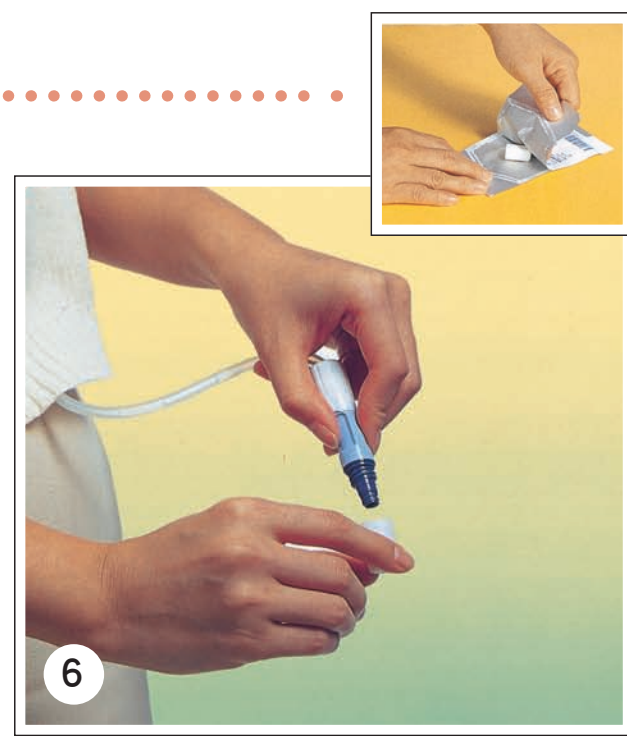

UltraBag System Configuration



Baxter

百特醫療產品股份有限公司

台北市106敦化南路二段216號15樓

腹膜透析諮詢專線：0800-009989